

- PROPOSED DEVELOPMENT AREAS
- PROPOSED APRON AREAS
- FUTURE PAVEMENTS
- EXISTING GAS
- EXISTING TELEPHONE
- EXISTING WATER
- EXISTING SANITARY
- EXISTING ELECTRIC
- EXISTING STORM SEWER
- EXISTING AIRPORT PROPERTY LINE
- EXISTING FLOODWAY
- EXISTING FLOODPLAIN

**NOTES:**  
 1. THESE SITES HAVE FLOOD PLAIN RESTRICTIONS  
 2. ASR = AIRFIELD SURVEILLANCE RADAR

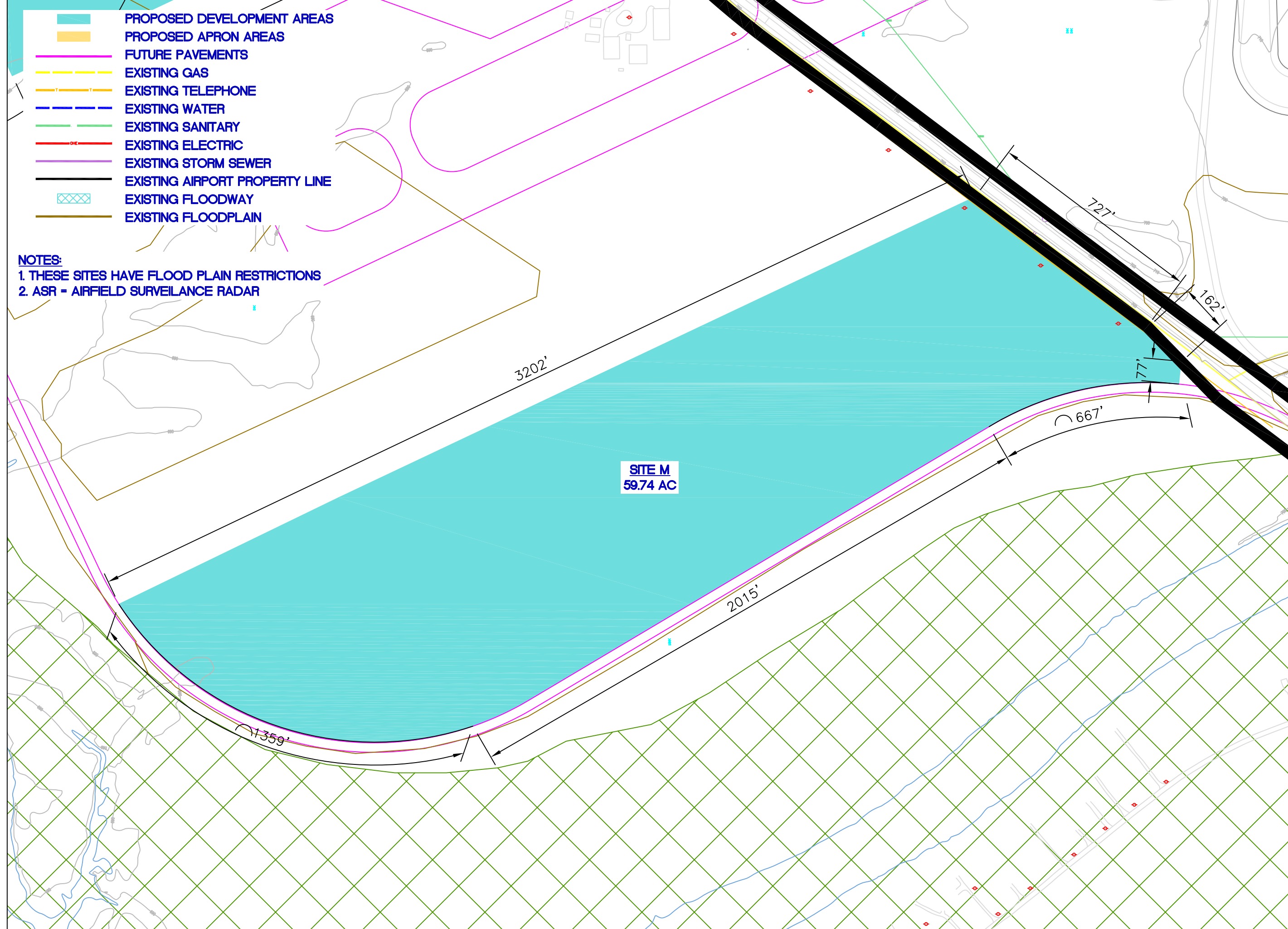

REVISIONS		
NUMBER	BY	DATE

0 1  
 THIS BAR IS EQUAL TO 1"  
 AT FULL SCALE (17X11).

**GREATER ROCKFORD AIRPORT**  
**ROCKFORD, ILLINOIS**

**PROPOSED DEVELOPMENT**  
**AREAS AND FUTURE PAVEMENTS**

© Copyright CMT, Inc.

**CMT**  
 CRAWFORD, MURPHY & TILLY, INC.  
 CONSULTING ENGINEERS  
 License No. 184-000613

**Chicago / Rockford International Airport**

DESIGN BY:  
 DRAWN BY: CMT / RFD  
 CHECKED BY:  
 APPROVED BY:  
 DATE: 07/18/07  
 JOB No: 07258-01-00

**SITE M**