

# INVITATION TO BID

**INVITATION TO BID #05-12**

**BID DESCRIPTION: Commercial Carpet and Installation**

**ISSUE DATE: March 30, 2005**

**BID OPENING DATE: Thursday, April 14, 2005**

**BID OPENING TIME: 10:00 am**

BID RESPONSES MUST BE RECEIVED NO LATER THAN THE PUBLIC BID OPENING DATE AND TIME (LOCAL TIME) SPECIFIED ABOVE. BIDS WILL BE OPENED AND READ ALOUD AT THAT TIME. LATE BIDS WILL NOT BE CONSIDERED.

## **TO ALL PROSPECTIVE CONTRACTORS/BIDDERS:**

You are hereby invited to submit your bid for the item(s) to be furnished and installed, shipped f.o.b. to the address specified herein.

All bids must be received in **DUPLICATE** in sealed envelopes.

All bids are subject to staff analysis and Board approval. The Greater Rockford Airport Authority (Authority) reserves the right to accept or reject any and all bids received and waive any and all technicalities.

Bids must be delivered prior to the public bid opening date and time to:

**Greater Rockford Airport Authority  
60 Airport Drive  
Rockford, IL 61109-2902**

Direct any and all inquiries about this bid to Amy M. Ott, Deputy Director of Finance & Administration, at 815-969-4445 or [aott@flyrfd.com](mailto:aott@flyrfd.com).

## Instructions to Bidders

---

### 1.1 Bid Preparation

Bids must be submitted, in duplicate, on the blank Bid Form furnished with these contract documents and shall conform to the terms and conditions set forth in the “Instructions to Bidders,” “General Terms and Conditions” and “Special Terms and Conditions” of the contract. Bids submitted in any other manner, or which fail to furnish all information or certificates required, may be summarily rejected. Bids may be modified or withdrawn prior to the time specified for the opening of bids. Bids shall be filled out legibly in ink or typewritten with all erasures, strikeouts and corrections initialed in ink by the person signing the bid.

### 1.2 Bid Execution

If the Bidder is a corporation, the President shall execute the bid. In the event that the bid is executed by other than the President, a certified copy of that section of the corporate by-laws or other authorization by the corporation, which permits the person to execute the bid for the corporation, shall be submitted. If the Bidder is a partnership, all partners shall execute the bid, unless one partner has been authorized to sign for the partnership, in which case, evidence of such authority satisfactory to the Deputy Director/Finance & Administration shall be submitted. If the Bidder is a sole proprietor, the owner shall execute the bid. A “Partnership” or “Sole Proprietor” operating under an Assumed Name shall be registered with the Illinois County in which located, as provided in the Illinois Compiled Statutes, 805/ILCS 405/1.

### 1.3 Bid Submission

The Greater Rockford Airport Authority must receive all bids by the specified opening time of the bid. Bids arriving after the specified time will not be accepted and will be returned unopened. All bids shall be submitted in sealed envelopes with the following information explicitly shown (centered both vertically and horizontally on the envelope): name and address of bidder and bid number. Further, the sealed envelope must be clearly marked “SEALED BID.” The Bidder shall be responsible for the delivery of the bid before the date and hour set forth for the opening of bids.

### 1.4 Error in Bid

Bidders are cautioned to verify their bids before submission. Negligence on the part of the Bidder in preparing the bid confers no right for withdrawal or modifications of the bid after it has been opened. In case of error in the extension of prices in the bid, the unit price will prevail.

### 1.5 Variances and Deviations

Variances and deviations shall be described fully on the Bid Form. In the absence of such statement, the bid shall be considered as if submitted in strict compliance with all terms, conditions, and specifications; the Contractor shall be held liable. Contractors are cautioned to avoid making variances and deviations to the specifications, which may result in rejection of their bid.

### 1.6 Reserved Rights

Greater Rockford Airport Authority reserves the right at any time and for any reason to cancel this Invitation to Bid, accept or reject any or all bids or any portion thereof, or to accept an alternate bid. The Authority reserves the right to waive any immaterial defects or irregularities in any bid. The Authority may seek clarification from any Bidder at any time and failure to respond promptly is cause for rejection. The Authority has sixty (60) days to accept the bid.

### 1.7 Interpretation or Correction of Bidding Documents

Bidders shall promptly notify the Authority no later than one (1) week before bid opening of any ambiguity, inconsistency or error, which they may discover upon examination of the bidding documents. Interpretations, corrections and changes will be made by written addendum. Each bidder shall ascertain prior to submitting a bid that all addenda have been received and acknowledged in the bid. Oral explanations will not be binding.

### 1.8 Incurred Costs

The Authority will not be liable for any costs incurred by Bidders in replying to this Invitation to Bid.

1.9 No Bid Response

If your firm declines to bid on this invitation, but desires to remain on the Authority's Bidders' List for future invitations, please submit in a letter stating why you are declining to bid.

1.10 Basis of Award

It is the intent of the Authority to award a contract to the lowest responsible bidder meeting specifications. Further, the Authority reserves the right to determine the lowest responsible bidder in any way determined to be in the best interests of the Authority. Award will be based on the following factors (where applicable): (a) adherence to all conditions and requirements of the bid specifications; (b) price; (c) qualifications of the bidder, including past performance, financial responsibility, general reputation, experience, service capabilities, and facilities; (d) delivery or completion date; (e) product appearance, workmanship, finish, taste, feel, overall quality, and results of product testing; (f) maintenance costs and warranty provisions; and (g) repurchase or residual value.

1.11 Pre-Bid Conference

If your firm has questions regarding the area for installation or would like to view or measure the area please contact Dave Lindberg at 815.703.5307 to set up a time.

*End of Instructions to Bidders*

## General Terms and Conditions

---

### 2.1 Non-Discrimination

Contractor shall comply with the Illinois Human Rights Act, 775, ILCS 5/1-101 et seq., as amended and any rules and regulations promulgated in accordance therewith, including, but not limited to the Equal Opportunity Clause, Illinois Administrative Code, Title 44, Part 750 (Appendix A), which is incorporated herein by reference. Furthermore, the Contractor shall comply with the Public Works Employment Discrimination Act, 775 ILCS 10/0.01 et seq., as amended.

During the performance of this Contract, the Contractor agrees that it shall not discriminate against any worker, employee or applicant, or any member of the public, on the basis of race, color, religion, sex, national origin, ancestry, age, marital status, physical or mental handicap, or sexual orientation. Upon request of the Authority, the Contractor also agrees to submit in writing an affirmative action plan demonstrating compliance with equal employment opportunity laws and policies. Contractor further agrees that this clause will be incorporated by the Contractor in all contracts entered into with suppliers or materials or services, sub-contractors and all labor organizations furnishing skilled, unskilled and craft union skilled labor, or any other person or organization performing services in connection with this Contract.

### 2.2 Drug-Free Workplace

The Contractor agrees to provide a drug free workplace as provided for in the Drug Free Workplace Act, 30 ILCS 580/1, et seq.

### 2.3 Tax Exemption

The Greater Rockford Airport Authority is not subject to Federal Excise Tax. Per Illinois Compiled Statutes, 35 ILCS 120/2-5, the Greater Rockford Airport Authority is exempt from state and local taxes. Our exempt number is E9992-3521-04

### 2.4 Warranties

Contractor warrants that all goods and services furnished hereunder will conform in all respects to the terms of this solicitation, including any drawings, specifications or standards incorporated herein, and that they will be free from latent and patent defects in materials, workmanship and title, and will be free from such defects in design. In addition, Contractor warrants that said goods and services are suitable for, and will perform in accordance with, the purposes for which they are purchased, fabricated, manufactured and designed or for such other purposes as are expressly specified in this solicitation. The Authority may return any nonconforming or defective items to the Contractor or require correction or replacement of the item at the time the defect is discovered, all at the Contractor's risk and expense. Acceptance shall not relieve the Contractor of its responsibility.

The Contractor further agrees, upon written notice from the Authority, to promptly and without charge, make changes, corrections and/or replacement, to the satisfaction of the Authority, which may be required to make good all defects in design and material under its intended use, for a period of one (1) year, with the one (1) year period commencing on the date of acceptance by the Authority. The Contractor shall receive no compensation for cost in replacement of goods or workmanship.

### 2.5 Indemnification

Contractor agrees to indemnify, save harmless and defend the Greater Rockford Airport Authority, its agents, servants, Commissioners, and employees, and each of them against and hold it and them harmless from any and all lawsuits, claims, demands, liabilities, losses or expenses, including court costs and attorneys' fees, for or on account of any injury to any person, or any death at any time resulting from such injury, or any damage to any property, which may arise or which may be alleged to have arisen, in whole or in part, out of or in connection with the work covered by this contract. The foregoing indemnity shall apply except if such injury, death or damage is caused directly and solely by the negligence or other fault of the Greater Rockford Airport Authority, its agents, servants, Commissioners, or employees or any other person indemnified hereunder. This indemnification obligation is not limited by, but is in addition to the insurance obligations, which may be contained in this contract. The provision of this paragraph shall not be waived.

## General Terms and Conditions

---

### 2.6 Termination and Default

Time is of the essence of this contract and if delivery of acceptable items or rendering of services is not completed by the time promised, the Authority reserves the right, without liability, in addition to its other rights and remedies, to terminate the contract by notice effective when received by Contractor, as to stated items not yet shipped or services not yet rendered and to purchase substitute items or services elsewhere and charge the Contractor with any or all losses incurred. The Authority shall be entitled to recover its attorney's fees and expenses in any successful action by the Authority to enforce this contract.

### 2.7 Royalties and Patents

Contractor shall pay all royalties and license fees. Contractor shall defend all suits or claims for infringement of any patent, copyright or trademark rights and shall hold the Authority harmless from loss on account thereof.

### 2.8 Regulatory Compliance

Contractor represents and warrants that the goods or services furnished hereunder (including all labels, packages and containers for said goods) comply with all applicable standards, rules and regulations in effect under the requirements of all Federal, State and local laws, rules and regulations as applicable, including the Occupational Safety and Health Act as amended, with respect to design, construction, manufacture or use for their intended purpose of said goods or services. Contractor shall furnish "Material Safety Data Sheets" in compliance with the Illinois Toxic Substances Disclosure to Employees Act.

Pursuant to Illinois Municipal Code 65 ILCS 5/11-42.1-1, by signing this bid the Contractor certifies that it is not delinquent in the payment of any tax administered by the Department of Revenue.

The Contractor certifies that they are not barred from bidding on this contract as a result of engaging in or being convicted of: (a) bid-rigging in violation of Section 3; or (b) bid-rotating in violation of Section 4, of the Illinois Criminal Code of 1961, as amended [720 ILCS 5/33E-3 and 4].

### 2.9 Discounts

Prices quoted must be net after deducting all trade and quantity discounts. Where cash discounts for prompt payment are offered, the discount period shall begin with the date of receipt of a correct invoice or receipt or final acceptance of goods, whichever is later.

### 2.10 Inspections

The Authority shall have the right to inspect any materials, components, equipment, supplies, services, or completed work specified herein. Any of said items not complying with these specifications are subject to rejection at the option of the Authority. Any items rejected shall be removed from the premises of the Authority and/or replaced at the entire expense of the Contractor.

### 2.11 References

To allow the Authority to evaluate the experience of the Contractor, as it relates to this purchase, the Contractor must submit a minimum of three (3) references of organizations that have purchased similar items. Failure to include references may result in bid disqualification. References must be submitted on the Bid Form.

### 2.12 Law Governing

This contract shall be governed by and construed according to the laws of the State of Illinois.

### 2.13 Prevailing Wage

Contractor shall not pay, and shall cause its subcontractors to not pay, less than the general prevailing rate of hourly wages for work of a similar character in the locality in which the work is performed and not less than general prevailing rate of hourly wages for legal holidays and overtime work in the performance of work under this contract, as established by the Illinois Department of Labor, pursuant to an act of the General Assembly of the State of Illinois approved June 26, 1941 as amended according to the Illinois Revised Statutes, Chapter 48, Section 39s-1 et seq. Pursuant to Illinois Revised Statutes, Chapter 48, Section 39s-5, the Contractor shall keep, and shall cause each subcontractor to keep, an accurate record showing the names and occupation of all laborers, workers and mechanics employed by them, and also showing the actual hourly wages paid to each individual, which record shall be open at all reasonable hours to inspection by the Authority, its officers and agents, and to agents of the Illinois Department of Labor. The Contractor hereby agrees to defend, indemnify, and hold harmless the Authority and the Authority's agents from any and all claims, demands, liens or suits of any kind or nature whatsoever (including suits for injunctive relief) by the Illinois Department of Labor under the Illinois Prevailing Wage Act, Illinois Revised Statutes, Chapter 48, Section 39s-1, et seq., or by any laborer, worker or mechanic employed by the Contractor or the subcontractor who alleges that he has been paid for his services in a sum less than prevailing wage rates required by Illinois law. The Authority agrees to notify the Contractor of any such claim, demand, lien or suit pending. The Winnebago County Prevailing Wage Worksheet for April 2005 is attached.

***End of General Terms and Conditions***

Revised 8/01

## Special Terms and Conditions

### 3.1 Pricing

The price quoted for each item is the full purchase price, including delivery to destination, and includes all transportation and handling charges, premiums on bonds, material or service costs, patent royalties and all other overhead charges of every kind and nature. Unless otherwise specified, prices shall remain firm for the contract period.

### 3.2 Specifications

Labor and material for Commercial Carpet intended for high traffic areas to be used in Airline Terminal passenger holding areas with construction fire ratings, static control and appearance appropriate for this use. See attached layout schematic. The product type shall be Modular. The following are the **minimum** material requirements:

Fiber type:	Type 6, 6.6 or equal
Secondary backing:	Reinforced vinyl composite with recycled content
Construction:	Tufted
Dye method:	Solution
Gauge:	1/12 in.
Pile density:	7,000
Stitches:	8.5
Width:	18 x18 or 24 x24
Pile weight:	20 oz per sq. yard

#### Other Requirements:

Flammability:	ASTM E648
Smoke density:	ASTM E662
Static propensity:	AATCC 134

### 3.3 Literature

Submit manufacturer's product literature and installation instructions for each recommended carpet.

### 3.4 Samples

Submit manufacturer's standard size samples and color yarns that illustrate the full range of colors, textures and patterns available.

### 3.5 Retainer

The Authority will retain 10% of the total bid package until final inspection is deemed full and complete.

### 3.6 Invoicing and Payment

The goal of the Authority is to pay properly submitted Contractor invoices within thirty (30) days of receipt, providing goods have been delivered and/or services have been performed, approved and accepted by the Greater Rockford Airport Authority. Original invoices must be presented for payment.

### 3.7 Insurance

The Contractor shall maintain at all times a minimum commercial liability insurance policy in the amount of \$1,000,000.00 and must name the Greater Rockford Airport Authority as additional insured on Contractors policy. Proof of adequate insurance in the form of a Certificate of Insurance must be provided to the Authority upon contract acceptance.

### 3.8 Installation

The Contractor shall be responsible for installation of the carpet and shall include the cost to install on the Bid Form.

### 3.9 Warranty

The warranty period shall be ten (10) years after the date of substantial completion. Chair pads shall not be required for carpet warranty coverage.

***End of Special Terms and Conditions***

Full Name of Bidder: \_\_\_\_\_

Business Address: \_\_\_\_\_

City, State, Zip: \_\_\_\_\_

Telephone Number: \_\_\_\_\_ FAX: \_\_\_\_\_

Email: \_\_\_\_\_

Contract Person: \_\_\_\_\_

FEIN: \_\_\_\_\_

The undersigned, being duly sworn, certifies that he/she is:

- The Owner/  
Sole Proprietor       a Member of the  
Partnership       an Officer of the  
Corporation       a Member of the  
Joint Venture

Further, the Contractor declares that the only person or parties interested in this bid as principals are those named herein.

Further, the undersigned hereby certifies that they have read and understand the contents of this bid and agree to furnish at the prices shown any or all of the items above, subject to all instructions, conditions, specifications, warranties and attachments, including Addenda No. \_\_\_\_\_ and \_\_\_\_\_ issued thereto, except only to the extent that the Contractor has taken express written exception in this bid, hereto. Failure to have read all the provisions of this bid shall not be cause to alter any resulting contract or request additional compensations.

Further, by signing this bid document, the bidder hereby certifies that they are not barred from bidding on this contract as a result of a violation of either Section 33E-3 or 33E-4 of the Illinois Criminal Code of 1961, as amended.

Further, by signing this bid document, the Contractor hereby certifies that pursuant to Illinois Compiled Statutes, 65 ILCS 5/11-42-1, the Contractor is not delinquent in the payment of any tax administered by the Department of Revenue.

Our State of Illinois Certification Number under the Fair Employment Practices Law is \_\_\_\_\_.

- (check if applicable) We do not have a State Pre-Qualification Statement. In lieu thereof, we will make an application at 312.814.2432 within thirty (30) days from the date of this bid opening.

Further, the Contractor agrees to provide a drug free workplace as provided for in the Drug Free Workplace Act, 30 ILCS 580.1 et seq.

**Authorized Signature:** \_\_\_\_\_

**Typed/Printed Name:** \_\_\_\_\_

**Title:** \_\_\_\_\_

**Date:** \_\_\_\_\_

Please complete one segment per sample. (Make additional copies if necessary.)

Sample # 1

**Carpet Product** \_\_\_\_\_

	<u>Per sq. ft.</u>	<u>Total</u>
Carpet	\$ _____	\$ _____
6" Wall Base	\$ _____	\$ _____
Installation	\$ _____	\$ _____
Removal & disposal of existing carpet		\$ _____
Total for 5,800 sq. ft. of carpet		\$ _____

Delivery or Completion Time \_\_\_\_\_

Sample #2

**Carpet Product** \_\_\_\_\_

	<u>Per sq. ft.</u>	<u>Total</u>
Carpet	\$ _____	\$ _____
6" Wall Base	\$ _____	\$ _____
Installation	\$ _____	\$ _____
Removal & disposal of existing carpet		\$ _____
Total for 5,800 sq. ft. of carpet		\$ _____

Delivery or Completion Time \_\_\_\_\_

Please complete one segment per sample. (Make additional copies if necessary.)

Sample # \_\_\_\_\_

**Carpet Product** \_\_\_\_\_

	<u>Per sq. ft.</u>	<u>Total</u>
Carpet	\$ _____	\$ _____
Installation	\$ _____	\$ _____
Removal & disposal of existing carpet		\$ _____
Total for 5,800 sq. ft. of carpet		\$ _____
Delivery or Completion Time	_____	

Sample # \_\_\_\_\_

**Carpet Product** \_\_\_\_\_

	<u>Per sq. ft.</u>	<u>Total</u>
Carpet	\$ _____	\$ _____
Installation	\$ _____	\$ _____
Removal & disposal of existing carpet		\$ _____
Total for 5,800 sq. ft. of carpet		\$ _____
Delivery or Completion Time	_____	

Variances and Deviations

Variance 1: \_\_\_\_\_  
\_\_\_\_\_

Variance 2: \_\_\_\_\_  
\_\_\_\_\_

Variance 3: \_\_\_\_\_  
\_\_\_\_\_

Variance 4: \_\_\_\_\_  
\_\_\_\_\_

References

Company Name: \_\_\_\_\_

Address: \_\_\_\_\_

\_\_\_\_\_

Contact Person: \_\_\_\_\_

Telephone #: \_\_\_\_\_

Company Name: \_\_\_\_\_

Address: \_\_\_\_\_

\_\_\_\_\_

Contact Person: \_\_\_\_\_

Telephone #: \_\_\_\_\_

Company Name: \_\_\_\_\_

Address: \_\_\_\_\_

\_\_\_\_\_

Contact Person: \_\_\_\_\_

Telephone #: \_\_\_\_\_

Company Name: \_\_\_\_\_

Address: \_\_\_\_\_

\_\_\_\_\_

Contact Person: \_\_\_\_\_

Telephone #: \_\_\_\_\_

NORTHWEST Chicago International Airport Terminal Building  
 Second Floor of Terminal Building

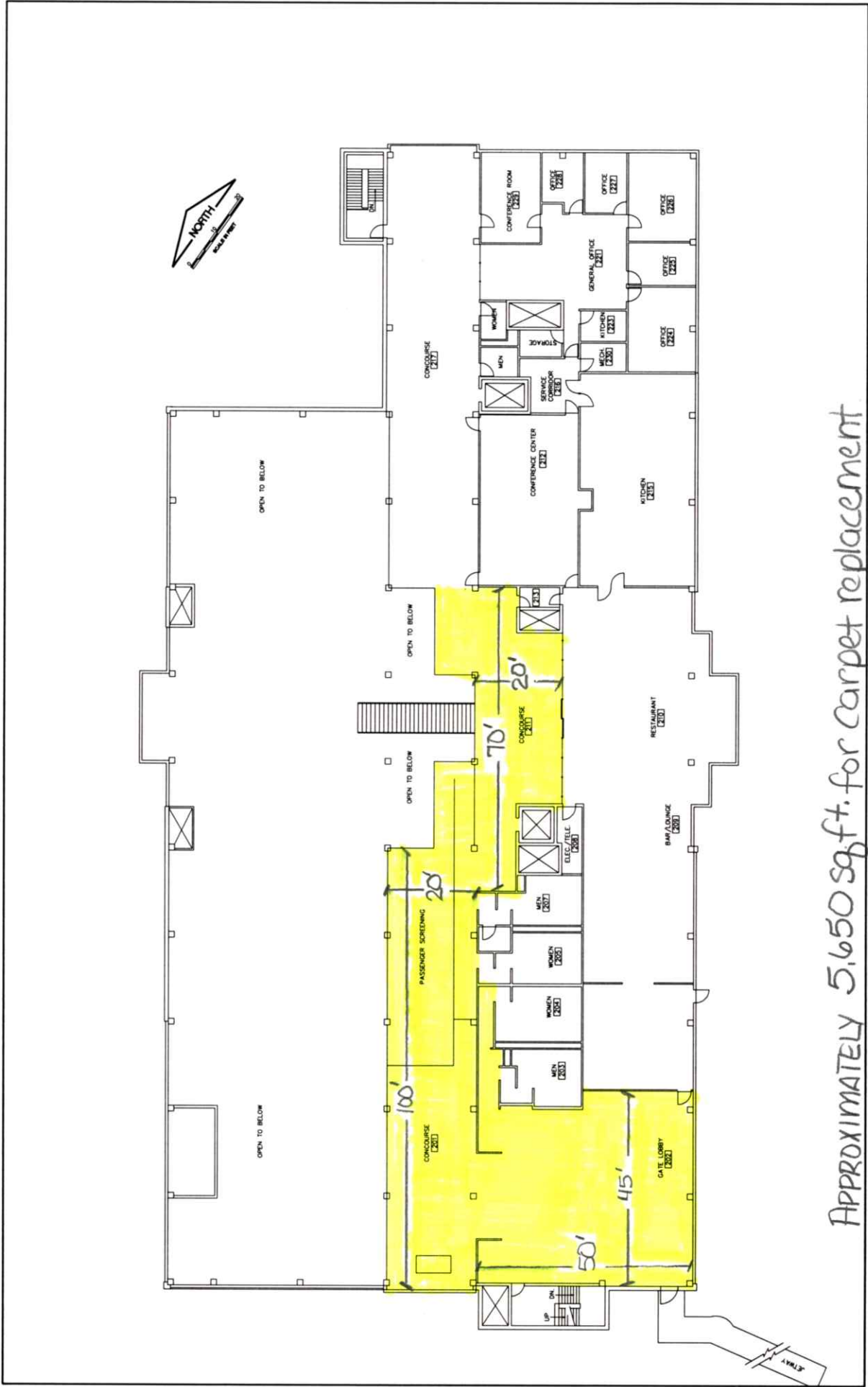

APPROXIMATELY 5,650 sq.ft. for carpet replacement

## Winnebago County Prevailing Wage for April 2005

Trade Name	RG	TYP	C	Base	FRMAN	*M-F>8	OSA	OSH	H/W	Pensn	Vac	Trng
=====	==	===	=	=====	=====	=====	===	===	=====	=====	=====	=====
ASBESTOS ABT-GEN		BLD		21.840	22.840	1.5	1.5	2.0	5.000	7.500	0.000	0.500
ASBESTOS ABT-MEC		BLD		18.950	0.000	1.5	1.5	2.0	2.700	3.350	0.000	0.000
BOILERMAKER		BLD		36.820	40.140	2.0	2.0	2.0	6.920	6.260	0.000	0.210
BRICK MASON		BLD		28.000	30.000	1.5	1.5	2.0	4.800	6.920	0.000	0.350
CARPENTER		BLD		26.880	29.840	1.5	1.5	2.0	4.800	6.950	0.000	0.600
CARPENTER		HWY		26.050	27.800	1.5	1.5	2.0	4.800	6.330	0.000	0.310
CEMENT MASON		ALL		27.240	29.490	1.5	1.5	2.0	4.800	6.760	0.000	0.050
CERAMIC TILE FNSHER		BLD		22.930	0.000	1.5	1.5	2.0	4.800	3.500	0.000	0.320
COMMUNICATION TECH		BLD		26.000	28.000	1.5	1.5	2.0	7.500	7.770	0.000	0.390
ELECTRIC PWR EQMT OP		ALL		26.940	34.540	1.5	1.5	2.0	3.750	7.440	0.000	0.130
ELECTRIC PWR GRNDMAN		ALL		20.970	34.540	1.5	1.5	2.0	3.750	5.760	0.000	0.100
ELECTRIC PWR LINEMAN		ALL		31.980	34.540	1.5	1.5	2.0	3.750	8.850	0.000	0.160
ELECTRIC PWR TRK DRV		ALL		21.640	34.540	1.5	1.5	2.0	3.750	5.950	0.000	0.110
ELECTRICIAN		BLD		31.000	34.200	1.5	1.5	2.0	7.500	9.770	0.000	0.360
ELEVATOR CONSTRUCTOR		BLD		35.570	40.020	2.0	2.0	2.0	7.275	3.420	2.130	0.000
GLAZIER		BLD		27.180	28.180	1.5	1.5	2.0	5.150	5.250	0.000	0.300
HT/FROST INSULATOR		BLD		27.680	29.760	1.5	1.5	2.0	5.400	7.270	0.000	0.000
IRON WORKER		ALL		29.450	30.920	2.0	2.0	2.0	6.350	13.53	0.000	0.550
LABORER		BLD		21.840	22.840	1.5	1.5	2.0	5.000	7.500	0.000	0.500
LABORER		HWY		20.990	21.740	1.5	1.5	2.0	5.000	7.500	0.000	0.500
LABORER, SKILLED		HWY		22.090	22.840	1.5	1.5	2.0	5.000	7.500	0.000	0.500
LATHER		BLD		26.880	29.840	1.5	1.5	2.0	4.800	6.950	0.000	0.600
MACHINIST		BLD		34.540	36.290	2.0	2.0	2.0	3.200	4.100	2.380	0.000
MARBLE FINISHERS		BLD		22.930	0.000	1.5	1.5	2.0	4.800	3.500	0.000	0.320
MARBLE MASON		BLD		25.530	25.780	1.5	1.5	2.0	4.800	5.000	0.000	0.320
MILLWRIGHT		BLD		31.150	34.270	1.5	1.5	2.0	4.800	9.300	0.000	0.560
OPERATING ENGINEER		BLD 1		34.050	38.050	2.0	2.0	2.0	5.800	5.100	1.800	0.550
OPERATING ENGINEER		BLD 2		33.350	38.050	2.0	2.0	2.0	5.800	5.100	1.800	0.550
OPERATING ENGINEER		BLD 3		30.900	38.050	2.0	2.0	2.0	5.800	5.100	1.800	0.550
OPERATING ENGINEER		BLD 4		28.900	38.050	2.0	2.0	2.0	5.800	5.100	1.800	0.550
OPERATING ENGINEER		HWY 1		33.900	37.900	1.5	1.5	2.0	5.800	5.100	1.800	0.550
OPERATING ENGINEER		HWY 2		33.350	37.900	1.5	1.5	2.0	5.800	5.100	1.800	0.550
OPERATING ENGINEER		HWY 3		32.050	37.900	1.5	1.5	2.0	5.800	5.100	1.800	0.550
OPERATING ENGINEER		HWY 4		30.500	37.900	1.5	1.5	2.0	5.800	5.100	1.800	0.550
OPERATING ENGINEER		HWY 5		29.150	37.900	1.5	1.5	2.0	5.800	5.100	1.800	0.550
PAINTER		ALL		28.100	29.100	1.5	1.5	1.5	4.850	4.200	0.000	0.250
PILEDRIIVER		BLD		27.880	30.950	1.5	1.5	2.0	4.800	6.950	0.000	0.600
PILEDRIIVER		HWY		26.050	27.800	1.5	1.5	2.0	4.800	6.330	0.000	0.310
PIPEFITTER		BLD		31.800	34.030	1.5	1.5	2.0	5.430	6.130	0.000	0.550
PLASTERER		BLD		27.200	29.920	1.5	1.5	2.0	4.800	6.310	0.000	0.050
PLUMBER		BLD		31.800	34.030	1.5	1.5	2.0	5.430	6.130	0.000	0.550
ROOFER		BLD		31.950	33.950	1.5	1.5	2.0	5.470	2.950	0.000	0.330
SHEETMETAL WORKER		BLD		29.690	31.620	1.5	1.5	2.0	4.400	8.850	0.520	0.290
SPRINKLER FITTER		BLD		29.390	30.890	1.5	1.5	2.0	6.100	4.950	0.000	0.250
STONE MASON		BLD		28.000	30.000	1.5	1.5	2.0	4.800	6.920	0.000	0.350
TERRAZZO FINISHER		BLD		22.930	0.000	1.5	1.5	2.0	4.800	3.500	0.000	0.320
TERRAZZO MASON		BLD		25.530	25.780	1.5	1.5	2.0	4.800	5.000	0.000	0.320
TILE LAYER		BLD		26.880	29.840	1.5	1.5	2.0	4.800	6.950	0.000	0.600
TILE MASON		BLD		25.530	25.780	1.5	1.5	2.0	4.800	5.000	0.000	0.320
TRUCK DRIVER		ALL 1		24.180	24.730	1.5	1.5	2.0	4.350	6.200	0.000	0.000
TRUCK DRIVER		ALL 2		24.330	24.730	1.5	1.5	2.0	4.350	6.200	0.000	0.000
TRUCK DRIVER		ALL 3		24.530	24.730	1.5	1.5	2.0	4.350	6.200	0.000	0.000
TRUCK DRIVER		ALL 4		24.730	24.730	1.5	1.5	2.0	4.350	6.200	0.000	0.000
TUCKPOINTER		BLD		28.000	30.000	1.5	1.5	2.0	4.800	6.920	0.000	0.350

**Legend:**

M-F>8 (Overtime is required for any hour greater than 8 worked each day, Monday through Friday.)  
 OSA (Overtime is required for every hour worked on Saturday)  
 OSH (Overtime is required for every hour worked on Sunday and Holidays)  
 H/W (Health & Welfare Insurance)  
 Pensn (Pension)  
 Vac (Vacation)  
 Trng (Training)

**Explanations**

## WINNEBAGO COUNTY

The following list is considered as those days for which holiday rates of wages for work performed apply: New Years Day, Memorial/Decoration Day, Fourth of July, Labor Day, Veterans Day, Thanksgiving Day, Christmas Day. Generally, any of these holidays which fall on a Sunday is celebrated on the following Monday. This then makes work performed on that Monday payable at the appropriate overtime rate for holiday pay. Common practice in a given local may alter certain days of celebration such as the day after Thanksgiving for Veterans Day. If in doubt, please check with IDOL.

## EXPLANATION OF CLASSES

ASBESTOS - GENERAL - removal of asbestos material/mold and hazardous materials from any place in a building, including mechanical systems where those mechanical systems are to be removed. This includes the removal of asbestos materials/mold and hazardous materials from ductwork or pipes in a building when the building is to be demolished at the time or at some close future date.

ASBESTOS - MECHANICAL - removal of asbestos material from mechanical systems, such as pipes, ducts, and boilers, where the mechanical systems are to remain.

## CERAMIC TILE FINISHER, MARBLE FINISHER, TERRAZZO FINISHER

Assisting, helping or supporting the tile, marble and terrazzo mechanic by performing their historic and traditional work assignments required to complete the proper installation of the work covered by said crafts. The term "Ceramic" is used for naming the classification only and is in no way a limitation of the product handled. Ceramic takes into consideration most hard tiles.

## COMMUNICATIONS TECHNICIAN

Installing, manufacturing, assembling and maintaining sound and intercom, protection alarm (security), fire alarm, master antenna television, closed circuit television, low voltage control for computers and/or door monitoring, school communications systems, telephones and servicing of nurse and emergency calls, and the installation and maintenance of transmit and receive antennas, transmitters, receivers, and associated apparatus which operates in conjunction with above systems. All work associated with these system installations will be included EXCEPT the installation of protective metallic conduit in new construction projects (excluding

less than ten-foot, runs strictly for protection of cable) and 120 volt AC (or higher) power wiring and associated hardware.

#### LABORER, SKILLED - HIGHWAY

Individuals engaged in the following types of work, irrespective of the site of the work: asbestos abatement worker, handling of any materials with any foreign matter harmful to skin or clothing, track laborer, cement handlers, chloride handlers, the unloading and loading with steel workers and re-bars, concrete workers wet, tunnel helpers in free air, batch dumpers, mason tenders, kettle and tar men, tank cleaners, plastic installers, scaffold workers, motorized buggies or motorized unit used for wet concrete or handling of building materials, laborers with de-watering systems, sewer workers plus depth, rod and chainmen with technical engineers, rod and chainmen with land surveyors, rod and chainmen with surveyors, vibrator operators, cement silica, clay, fly ash, lime and plasters, handlers (bulk or bag), cofferdam workers plus depth, on concrete paving, placing, cutting and tying of reinforcing, deck hand, dredge hand, and shore laborers, bankmen on floating plant, grade checker, power tools, front end man on chip spreaders, cession workers plus depth, gunnite nozzle men, lead man on sewer work, welders, cutters, burners and torchmen, chainsaw operators, jackhammer and drill operators, layout man and/or drainage tile layer, steel form setter - street and highway, air tamping hammermen, signal man on crane, concrete saw operator, screedman on asphalt pavers, laborers tending masons with hot material or where foreign materials are used, mortar mixer operators, multiple concrete duct - leadsman, lumen, asphalt raker, curb asphalt machine operator, ready mix scalemen (permanent, portable or temporary plant), laborers handling masterplate or similar materials, laser beam operator, con-crete burning machine operator, coring machine operator, plaster ten-der, underpinning and shoring of buildings, pump men, manhole and catch basin, dirt and stone tamper, hose men on concrete pumps, haz-ardous waste worker, lead base paint abatement worker, lining of pipe, refusing machine, assisting on direct boring machine, the work of lay-ing watermain, fire hydrants, all mechanical joints to watermain work, sewer worker, and tapping water service and forced lift station mechanical worker.

#### TRUCK DRIVER - BUILDING, HEAVY AND HIGHWAY CONSTRUCTION

Class 1. Two or three Axle Trucks. A-frame Truck when used for transportation purposes; Air Compressors and Welding Machines, including those pulled by cars, pick-up trucks and tractors; Ambulances; Batch Gate Lockers; Batch Hopperman; Car and Truck Washers; Carry-alls; Fork Lifts and Hoisters; Helpers; Mechanics Helpers and Greasers; Oil Distributors 2-man operation; Pavement Breakers; Pole Trailer, up to 40 feet; Power Mower Tractors; Self-propelled Chip Spreader; Skipman; Slurry Trucks, 2-man operation; Slurry Truck Conveyor Operation, 2 or 3 man; TTeamsters Unskilled dumpman; and Truck Drivers hauling warning lights, barricades, and portable toilets on the job site.

Class 2. Four axle trucks; Dump Crets and Adgetors under 7 yards; Dumpsters, Track Trucks, Euclids, Hug Bottom Dump Turnapulls or Turnatrailers when pulling other than self-loading equipment or similar equipment under 16 cubic yards; Mixer Trucks under 7 yards; Ready-mix Plant Hopper Operator, and Winch Trucks, 2 Axles.

Class 3. Five axle trucks; Dump Crets and Adgetors 7 yards and over; Dumpsters, Track Trucks, Euclids, Hug Bottom Dump Turnatrailers or turnapulls when pulling other than self-loading equipment or similar equipment over 16 cubic yards; Explosives and/or Fission Material Trucks; Mixer Trucks 7 yards or over; Mobile Cranes while in transit; Oil Distributors, 1-man operation; Pole Trailer, over 40 feet; Pole and Expandable Trailers hauling material over 50 feet long; Slurry trucks, 1-man operation; Winch trucks, 3 axles or more; Mechanic--Truck Welder and Truck Painter.

Class 4. Six axle trucks; Dual-purpose vehicles, such as mounted crane trucks with hoist and accessories; Foreman; Master Mechanic; Self-loading equipment like P.B. and trucks with scoops on the front.

#### OPERATING ENGINEERS - BUILDING

Class 1. Assistant Craft Foreman; Craft Foreman; Mechanic; Asphalt Plant; Asphalt Spreader; Autograde; Batch Plant; Benoto (requires Two Engineers); Boiler and Throttle Valve; Caisson Rigs; Central Redi-Mix Plant; Combination Back Hoe Front End-loader Machine; Compressor and Throttle Valve; Concrete Breaker (Truck Mounted); Concrete Conveyor; Concrete Paver; Concrete Placer; Concrete Pump (Truck Mounted); Concrete Tower, Cranes, All, Cranes, Hammerhead, Creter Crane; Crusher, Stone, etc.; Derricks, All; Derricks, Traveling; Formless Curb and Gutter Machine; Grader, Elevating; Grouting Machines; Highlift Shovels or Front Endloader 2-1/4 yd. and over; Hoists, Elevators, outside type rack and pinion and similar machines; Hoists, one, two and three Drum; Hoists, Two tigger One Floor; Hydraulic Backhoes; Hydraulic Boom Trucks; Locomotives, All; Motor Patrol; Pile Drivers and Skid Rig; Post Hole Digger; Pre-Stress Machine; Pump Cretes; Squeeze Cretes-screw Type Pumps; Gypsum Bulker and Pump; Raised and Blind Hole Drill; Rock Drill; Roto Mill Grinder; Scoops - Tractor Drawn; Slip-form Paver; Straddle Buggies; Tie Back Machine; Tractor with Book and Side Boom; Trenching Machines.

Class 2. Bobcat (over 3/4 cu. yd.); Boilers; Brick Forklift; Broom, All Power Propelled; Bulldozers; Concrete Mixer (Two Bag and Over); Conveyor, Portable; Forklift Trucks; Greaser Engineer; Highlift Shovels or Front Endloaders under 2-1/4 yd.; Hoists, Automatic; Hoists, Sewer Dragging Machine; Hoists, Tigger Single Drum; Rollers, All; Steam Generators; Tractors, All; Tractor Drawn Vibratory Roller; Winch Trucks with "A" Frame.

Class 3. Air Compressor; Asphalt Spreader; Combination - Small Equipment Operator; Generators; Heaters, Mechanical; Hoists, Inside Elevators - (Rheostat Manual Controlled); Hydraulic Power Units (Pile Driving and Extracting); Pumps, over 3" (1 to 3 not to exceed a total of 300 ft.); Pumps, Well Points; Welding Machines (2 through 5); Winches, 4 small Electric Drill Winches; Bobcat (up to and including 3/4 cu. yd.).

Class 4. Hoists, Inside Elevators, Push Button with Automatic Doors; Oilers; Brick Forklift.

#### OPERATING ENGINEERS - HEAVY AND HIGHWAY CONSTRUCTION

Class 1. Craft Foreman; Asphalt Plant, Asphalt Heater and Planer Combination; Asphalt Heater Scarfire; Asphalt Silo Tender; Asphalt Spreader; Autograder; ABG Paver; Backhoes with Caisson attachment; Ballast Regulator, Belt Loader; Caisson Rigs; Car Dumper; Central

Redi-Mix Plant; Backhoe w/shear attachments; Combination Backhoe Front Endloader Machine, (1 cu. yd. Backhoe Bucket or over or with attachments); Concrete Breaker (Truck Mounted); Concrete Conveyor; Concrete Paver over 27E cu. ft.; Concrete Placer; Concrete Tube Float; Cranes, all attachments; Cranes, Hammerhead, Linden, Peco & Machines of a like nature; Crete Crane; Crusher, Stone, etc.; Derricks, All; Derrick Boats; Derricks, Traveling; Directional Boring Machine over 12"; Dredges; Field Mechanic-Welder; Formless Curb and Gutter Machine; Gradall and Machines of a like nature; Grader, Elevating; Grader, Motor Grader, Motor Patrol, Auto Patrol, Form Grader, Pull Grader, Subgrader; Guard Rail Post Driver Mounted; Hoists, One, Two and Three Drum; Hydraulic Backhoes; Pile Drivers and Skid Rig; Pre-Stress Machine; Pump Cretes Dual Ram; Rock Drill - Crawler or Skid Rig; Rock Drill - Truck Mounted; Rock/Track Tamper; Roto Mill Grinder; Slip-Form Paver; Soil Test Drill Rig (Truck Mounted); Straddle Buggies; GCI Crane; Hydraulic Telescoping form (Tunnel); Tie Back Machine; Tractor Drawn Belt Loader; Tractor with Boom; Tractor-aire with Attachments; Traffic Barrier conveyor machine; Raised or Blind Hole; Trenching Machine; Truck Mounted Concrete Pump with Boom; Truck Mounted Concrete Conveyor; Underground Boring and/or Mining Machines; Wheel Excavator; Widener (APSCO).

Class 2. Batch Plant; Bituminous Mixer; Boiler and Throttle Valve; Bulldozers; Car Loader Trailing Conveyors; Combination Backhoe Front Endloader Machine (less than 1 cu. yd. Backhoe Bucket or over or with attachments); Compressor and Throttle Valve; Compressor, Common Receiver (3); Concrete Breaker or Hydro Hammer; Concrete Grinding Machine; Concrete Mixer or Paver 7S Series to and including 27 cu. ft.; Concrete Spreader; Concrete Curing Machine, Burlap Machine, Belting Machine and Sealing Machine; Conveyor Muck Cars (Haglund or Similar Type); Drills, all; Finishing Machine - Concrete; Greaser Engineer; Highlift Shovels or Front Endloader; Hoist - Sewer Dragging Machine; Hydraulic Boom Trucks (All Attachments); Hydro Blaster; Laser Screed; All Locomotives, Dinky; Pump Cretes; Squeeze Cretes-Screw Type Pumps, Gypsum Bulker and Pump; Roller, Asphalt; Rotary Snow Plows; Rototiller, Seaman, etc., self-propelled; Scoops - Tractor Drawn; Self-Propelled Compactor; Spreader - Chip - Stone, etc.; Scraper; Scraper - Prime Mover in Tandem (Regardless of Size); Tank Car Heater; Tractors, Push, Pulling Sheeps Foot, Disc, Compactor, etc. Tug Boats.

Class 3. Boilers; Brooms, All Power Propelled; Cement Supply Tender; Compressor, Common Receiver (2); Concrete Mixer (Two Bag and Over); Conveyor, Portable; Farm-Type Tractors Used for Mowing, Seeding, etc.; Fireman on Boilers; Forklift Trucks; Grouting Machine; Hoists, Automatic; Hoists, All Elevators; Hoists, Tugger Single Drum; Jeep Diggers, Low Boys; Pipe Jacking Machines; Post-Hole Digger; Power Saw, Concrete Power Driven; Pug Mills; Rollers, other than asphalt; Seed and Straw Blower; Steam Generators; Stump Machine; Winch Trucks with "A" Frame; Work Boats; Tamper - Form-Motor Driven.

Class 4. Air Compressor - Small and Large; Asphalt Spreader, Backend Man; Bobcat (Skid Steer) all; Combination - Small Equipment Operator; Directional Boring Machine up to 12"; Generators - Small 50kw and Under; Generators - Large over 50kw; Heaters, Mechanical; Hydraulic Power Unit (Pile Driving, Extracting, or Drilling); Hydro-Blaster; Light Plants, All (1 through 5); Pumps, over 3" (1 to 3 not to exceed a total of 300 ft.); Pumps, Well Points; Tract-aire; Welding Machines (2 through 5); Winches, 4 Small Electric Drill Winches.

Class 5. Oilers and Directional Boring Machine Locator.  
Other Classifications of Work:

For definitions of classifications not otherwise set out, the Department generally has on file such definitions which are available. If a task to be performed is not subject to one of the classifications of pay set out, the Department will upon being contacted state which neighboring county has such a classification and provide such rate, such rate being deemed to exist by reference in this document. If no neighboring county rate applies to the task, the Department shall undertake a special determination, such special determination being then deemed to have existed under this determination. If a project requires these, or any classification not listed, please contact IDOL at 618/993-7271 for wage rates or clarifications.

#### LANDSCAPING

Landscaping work falls under the existing classifications for laborer, operating engineer and truck driver. The work performed by landscape plantsman and landscape laborer is covered by the existing classification of laborer. The work performed by landscape operators (regardless of equipment used or its size) is covered by the classifications of operating engineer. The work performed by landscape truck drivers (regardless of size of truck driven) is covered by the classifications of truck driver.